

**vtech®**  
Baby

# User's Manual

## Little Friendlies Kick & Play Piano



© 2014 VTech  
Printed In China  
91-002917-001 (UK)



**VTech understands that a child's needs and abilities change as they grow and with that in mind we develop our toys to teach and entertain at just the right level...**

### **vtech Baby**

**Toys that will stimulate their interest in different textures, sounds and colours**

#### **I am...**

...responding to colours, sounds and textures

...understanding cause and effect

...learning to touch, reach, grasp, sit-up, crawl and toddle

**Birth-36 months**



### **Pre-School**

**Interactive toys to develop their imagination and encourage language development**

#### **I want...**

...to get ready for school by starting to learn the alphabet and counting

...my learning to be as fun, easy and exciting as can be

...to show my creativity with drawing and music so my whole brain develops

**3-6 years**



### **Electronic Learning Computers**

**Cool, aspirational and inspiring computers for curriculum related learning**

#### **I need...**

...challenging activities that can keep pace with my growing mind

...intelligent technology that adapts to my level of learning

...National Curriculum based content to support what I'm learning at school

**4-10 years**



To learn more about this and other VTech® products, visit [www.vtechuk.com](http://www.vtechuk.com)



# INTRODUCTION

Thank you for purchasing the **VTech® Little Friendlies Kick & Play Piano** learning toy.

Have fun with the **Little Friendlies Kick & Play Piano**. This soft musical keyboard features five Little Friendlies animals and can be used in or out of the cot. Kick or tap the five piano keys to learn about animals and instruments and hear playful sing-along songs. In the music mode, long playing melodies will help lull baby to sleep.

ON/OFF/VOLUME  
CONTROL SWITCH

ROLLER  
BALL

SLIDING  
OWL

LIGHT-UP  
MUSIC NOTE

LIGHT-UP  
SUN

MODE  
SELECTOR

5 SOFT PIANO  
BUTTONS

RABBIT  
BUTTON

2 DANGLING  
CHARACTERS

Introduction

# INCLUDED IN THIS PACKAGE

- One VTech® Little Friendlies Kick & Play Piano
- One instruction manual

**WARNING:** All packing materials, such as tape, plastic sheets, packaging locks and tags are not part of this toy, and should be discarded for your child's safety.

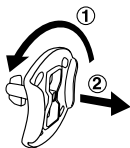

- ① Rotate the packing locks 90 degrees counter-clockwise
- ② Pull out the packing locks

**NOTE:** Please keep this instruction manual as it contains important information.

## GETTING STARTED

### BATTERY INSTALLATION

1. Make sure the unit is turned **OFF**.
2. Locate the battery cover on the bottom of the unit. Use a coin or a screwdriver to loosen the screw.
3. Install 2 new 'AA' (AM-3/LR6) batteries following the diagram inside the battery box. (The use of new alkaline batteries is recommended for maximum performance.)
4. Replace the battery cover and tighten the screw to secure.

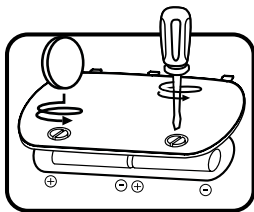



## BATTERY NOTICE

- Use new alkaline batteries for maximum performance.
- Use only batteries of the same or equivalent type as recommended.
- Do not mix different types of batteries: alkaline, standard (carbon-zinc) or rechargeable (Ni-Cd, Ni-MH), or new and used batteries.
- Do not use damaged batteries.
- Insert batteries with the correct polarity.
- Do not short-circuit the battery terminals.
- Remove exhausted batteries from the toy.
- Remove batteries during long periods of non-use.
- Do not dispose of batteries in fire.
- Do not charge non-rechargeable batteries.
- Remove rechargeable batteries from the toy before charging (if removable).
- Rechargeable batteries are only to be charged under adult supervision.

## IMPORTANT NOTE

With the **VTech® Little Friendlies Kick & Play Piano**, safety comes first. To ensure your child's safety, the assembly of this product is an adult activity, not a child's activity. Please ensure that the attachment strap is securely locked into position and the three strings are tied tightly to avoid injury. Please follow the instructions below carefully and make sure the final assembly is correct. Attach only to cots with sturdy rails and spindles. Do not attach to playpens with mesh walls. Please make sure the cot attachment strap is out of reach from children when placed in the cot.

## Disposal of batteries and product



The crossed-out wheellie bin symbols on products and batteries, or on their respective packaging, indicates they must not be disposed of in domestic waste as they contain substances that can be damaging to the environment and human health.



The chemical symbols Hg, Cd or Pb, where marked, indicate that the battery contains more than the specified value of mercury (Hg), cadmium (Cd) or lead (Pb) set out in Battery Directive (2006/66/EC).

The solid bar indicates that the product was placed on the market after 13th August, 2005.

Help protect the environment by disposing of your product or batteries responsibly.

For more information, please visit:

[www.recycle-more.co.uk](http://www.recycle-more.co.uk)

[www.recyclenow.com](http://www.recyclenow.com)



# ASSEMBLY INSTRUCTIONS

1. Place the unit inside the cot.

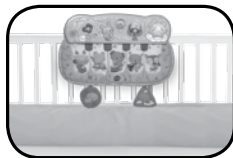

2. Loop the cot attachment strap around the nearest spindle and slide it under the slot on the back of the unit, pulling to secure.

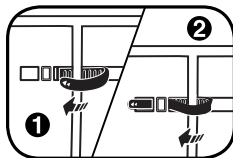

3. Once the cot attachment strap is securely fastened, please tie the three strings to the cot rail and the closest spindle. Pull slightly on the unit to make sure the strap and the three strings have been securely fastened. The unit should be snug against the cot rail. Please check the unit frequently to ensure it is still secure.

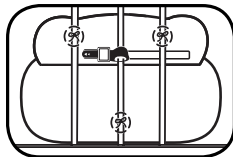
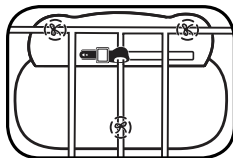

4. To remove the unit from the cot, untie the three strings, then hold down the square button near the cot attachment strap and pull the strap out of the slot.

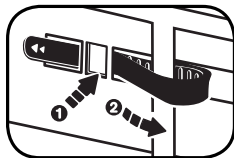

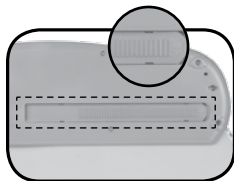

5. When the unit is being used outside of the cot as a floor toy, please make sure the cot attachment strap is clipped into the back of the unit.

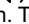

## PRODUCT FEATURES

### 1. ON/OFF/VOLUME CONTROL SWITCH

To turn the unit **ON**, slide the **ON/OFF/VOLUME CONTROL SWITCH** to the **LOW VOLUME** (  ) or **HIGH VOLUME** (  ) position. To turn the unit **OFF**, slide the **ON/OFF/VOLUME CONTROL SWITCH** to the **OFF** (  ) position.

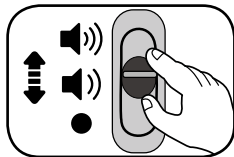

### 2. AUTOMATIC SHUT-OFF

To preserve battery life, the **VTech® Little Friendlies Kick & Play Piano** will automatically power-down after approximately 24 seconds without input in the learning mode and 8 seconds without input in the music mode. The unit can be turned on again by pressing any button.





## ACTIVITIES

1. Slide the **on/off/volume control switch** to turn the unit on. You will hear a song, a phrase and a short tune. The lights will flash with the sounds.
2. Press the **piano buttons** in the learning mode to hear animal names, instrument names, instrument sounds and songs. In the music mode you will hear piano notes, short tunes or animal sounds. The lights will flash with the sounds.
3. Slide the **owl** or press the **rabbit** to hear fun sounds and playful phrases in the learning mode. In the music mode you will hear music play for 15 minutes. While the melodies are playing, press the piano keys to hear fun sounds play over the melody. Continue pressing the piano keys or press the owl or rabbit buttons to interrupt the melodies. The lights will flash with the sounds.
4. Spin the **roller ball** in the learning mode to hear fun sounds, a phrase or a song. In the music mode you will hear short tunes or fun sounds. The lights will flash with the sounds.

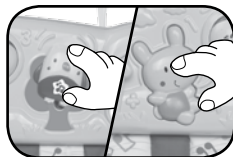
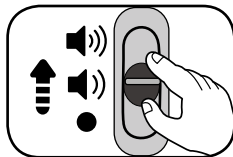



## MELODY LIST:

1. Toyland
2. All Through The Night
3. Are You Sleeping?
4. Good Morning Merry Sunshine
5. Lazy Mary Will You Get Up?
6. Here we go Looby Loo
7. Sing a Song of Sixpence
8. Did You Ever See a Lassie?
9. Polly Wolly Doodle
10. Ta-Ra-Ra Boom-De-Ay
11. Teddy Bears' Picnic
12. Turkey in the Straw
13. Aiken Drum
14. White Coral Bells
15. Humpty Dumpty
16. Jack and Jill
17. Twinkle, Twinkle, Little Star
18. Bear Went Over the Mountain
19. Mary, Mary Quite Contrary
20. Yankee Doodle



# SING-ALONG SONG LYRICS

## SONG 1

The animals are playing music in the sun.  
Singing, dancing and playing to the songs!

## SONG 2

Singing with the animals is so much fun!

## SONG 3

Peek-a-boo, little deer,  
Strumming a happy tune on the guitar.

## SONG 4

Ribbit-ribbit, little froggie,  
Tapping on the colourful xylophone.

## SONG 5

Rat-a-tat-tat, little doggie,  
Tapping a song on the drum.

## SONG 6

Toot-toot, little squirrel,  
Playing out loud on the trumpet!

## SONG 6

Rattle-rattle, little fox,  
Shaking the maracas in the air.



## CARE & MAINTENANCE

1. Keep the unit clean by wiping it with a slightly damp cloth.
2. Keep the unit out of direct sunlight and away from any direct heat source.
3. Make sure you empty the water out of all the elements of the unit and rinse thoroughly before drying so no sediment or cleaning products are left on the unit.
4. Make sure to dry all the elements of the unit before storing.
5. Remove the batteries when the unit will not be in use for an extended period of time.
6. Do not drop the unit on hard surfaces.

## TROUBLESHOOTING

If for some reason the program/activity stops working or malfunctions, please follow these steps:

1. Please turn the unit **OFF**.
2. Interrupt the power supply by removing the batteries.
3. Let the unit stand for a few minutes, then replace the batteries.
4. Turn the unit **ON**. The unit should now be ready to play again.
5. If the product still does not work, replace with an entire set of new batteries.

If the problem persists, please call our Consumer Services Department on 01235 546810 (from UK) or +44 1235 546810 (outside UK) and a service representative will be happy to help you.



### IMPORTANT NOTE:

Creating and developing **VTech®** products is accompanied by a responsibility that we take very seriously. We make every effort to ensure the accuracy of the information which forms the value of our products. However, errors sometimes can occur. It is important for you to know that we stand behind our products and encourage you to call our Consumer Services Department on 01235 546810 (from UK) or +44 1235 546810 (outside UK) with any problems and/or suggestions that you might have. A service representative will be happy to help you.





## PRODUCT WARRANTY



Thank you for choosing this quality product from VTech. We hope it will bring many hours of entertainment, imaginative play and learning.

1. The product detailed above is covered by a one year warranty from the date of purchase, against any defects in materials or workmanship.
2. The product may be returned to the place of purchase. Alternatively the product can be returned to VTech Electronics Europe plc (see address below), with proof of purchase, without proof of purchase no replacement will be provided.
3. VTech Electronics Europe plc will examine the product and if it is found to be defective due to faulty materials or workmanship, will replace the product at their discretion.
4. If the product covered by this warranty is damaged due to misuse, modification or unauthorised repair, or because of faulty batteries, battery discharge or incorrect electrical connections, then this warranty becomes void.
5. This warranty is personal to the original purchaser and is not transferable.
6. Breakages to the LCD screen are not covered by the warranty.
7. Returns to VTech Electronics Europe plc should include a cheque or postal order for £1.50 towards the cost of return postage and packaging.
8. Products returned to VTech Electronics Europe plc, should be addressed as follows and packed carefully to avoid damage in transit (Please do not include batteries or adaptor).  
Please include details of the fault together with your name and address.

VTech Electronics Europe plc, c/o Tablogix Limited, 200 Milton Park, Abingdon, Oxon OX14 4TA

**THIS WARRANTY IS OFFERED AS AN EXTRA BENEFIT AND DOES NOT AFFECT CONSUMERS' STATUTORY RIGHTS.**

**This warranty is valid for the UK and Eire only. For products purchased outside the UK and Eire, please contact your local distributor or place of purchase.**

Join the VTech club online at [www.vtechuk.com](http://www.vtechuk.com)

